

# **Hong Kong Regal Prosthesis Ltd.**

## **General Enquiry (Transportation)**

**Address:** Room 3D, Tower F, Mai Luen Industrial Building, 23-31 Kung Yip Street, Kwai Chung, NT, Hong Kong

**Tel:** +852 2771 8991 / 2780 0982

**E-mail:** [info@regalprosthesis.com](mailto:info@regalprosthesis.com)

**Working Hours:** Monday to Friday 8:30am to 6:30pm

Saturday Off

Sunday Off

### **The transportation between Hong Kong Control Points and Regal Prosthesis Ltd.**

#### **1. Hong Kong International Airport (Terminal 1: 24hours ; Terminal 2: 6:30am to 1:00 am)**

<b>Transportation</b>	<b>Fares (HKD)</b>	<b>Estimated Time</b>
Taxi	Around \$210 (include Lantau Link fees)	About 30 minutes
MTR (From Airport Station to Kwai Hing Station)	Adult: \$60 Child: \$30	About 40 minutes
Bus (Route A31> Kwai Hing Station)	Adult: \$18.9 Child: \$9.5	About 45 minutes

MTR Route: Take Airport Express from Airport, interchange to Tung Chung Line towards Hong Kong at Tsing Yi Station. Then, interchange to Tsuen Wan Line towards Tsuen Wan at Lai King Station. Take off at Kwai Hing Station.

#### **2. Lo Wu (6:30am to 11:45pm)**

<b>Transportation</b>	<b>Fare (HKD)</b>	<b>Estimated Time</b>
Taxi	Around \$200 (Exclude any tunnel fees)	About 40 minutes
MTR (From Lo Wu Station to Kwai Hing Station)	Adult: Octopus \$44 Ticket \$47.5 Child: Octopus \$22.3 Ticket \$23.5	About an hour

MTR Route: Take East Rail Line from Lo Wu, interchange to Kwun Tong Line towards Whampoa at Kowloon Tong Station. Then, interchange to Tsuen Wan Line towards Tsuen Wan at Price Edward Station. Take off at Kwai Hing Station.

#### **3. Hung Hom (6:30am to 11:45pm)**

<b>Transportation</b>	<b>Fare (HKD)</b>	<b>Estimated Time</b>
Taxi	Around \$100	About 20 minutes
MTR (From Hung Hom Station to Kwai Hing Station)	Adult: Octopus \$9.1 Ticket \$10.5 Child: Octopus \$4.3 Ticket \$4.5	About 23 minutes
Bus (Route 171> Mei Foo Station> Route 33A> Kwai Hing Station)	Adult: \$11.3 Child: \$5.7	About 40 minutes

MTR Route: Take West Rail Line from Hung Hom, interchange to Tung Chung Line towards Tung Chung at Nam Cheong Station. Then, interchange to Tsuen Wan Line towards Tsuen Wan at Lai King Station. Take off at Kwai Hing Station.

#### **4. Lok Ma Chau (24 hours)**

<b>Transportation</b>	<b>Fare (HKD)</b>	<b>Estimated Time</b>
Taxi	Around \$200 (Included Tai Lam Tunnel fee)	About 35 minutes
MTR (From Lok Ma Chau Station to Kwai Hing Station)	Adult: Octopus \$44 Ticket \$47.5 Child: Octopus \$22.3 Ticket \$23.5	About 1 hour

MTR Route: Take East Rail Line from Lok Ma Chau, interchange to Kwun Tong Line towards Whampoa at Kowloon Tong Station. Then, interchange to Tsuen Wan Line towards Tsuen Wan at Price Edward Station. Take off at Kwai Hing Station.

#### 5. China Ferry Terminal (TST) (6:00am to 00:00am)

Transportation	Fare (HKD)	Estimated Time
Taxi	Around \$80	About 20 minutes
Bus (Route 238X> Cheung Sha Wan Hing Wah Street> Route 33A> Kwai Hing Station)	Adult: \$13.7 Child: \$6.9	About 40 minutes

#### 6. Macau Ferry Terminal (Central) (24 hours)

Transportation	Fare (HKD)	Estimated Time
Taxi	Around \$150 (Included Western Harbour Crossing)	About 20 minutes
MTR (From Sheung Wan Station to Kwai Hing Station)	Adult: Octopus \$14.2      Ticket \$14.5 Child: Octopus \$6.7      Ticket \$7.5	About 30 minutes

MTR Route: Take Island Line from Sheung Wan towards Chai Wan, interchange to Tsuen Wan Line towards Tsuen Wan at Central Station. Take off at Kwai Hing Station.

#### Octopus Card

The Octopus Card is a reusable contactless stored value smart card for making electronic payments in online or offline systems in Hong Kong. It common used in public transportation, convenience stores, etc.

#### Authorized distribution outlets of Standard Octopus: All MTR Customer service centers

	Child 	Adult 	Elder 
Deposit	HK\$50	HK\$50	HK\$50
Initial stored value	HK\$20	HK\$100	HK\$20
Handling charge	—	—	—
Fare concession eligibility	Age 3-11	No concession	Check with transport companies

Hong Kong MTR Official Website: <http://www.mtr.com.hk/en/customer/main/index.html>

**Kwai Hing MTR Station to Hong Kong Regal Prosthesis Limited Head Office route**

(Room 3D, Tower F, Mai Luen Industrial Building., 23-31 Kung Yip Street, Kwai Chung, NT, Hong Kong)



Leave Kwai Hing Station from Exit A, cross Kwai Hing Road, across Kwai Chung Road using the bridge, walk along Kung Yip Street for about 5 minutes.



Mai Luen Industrial Building

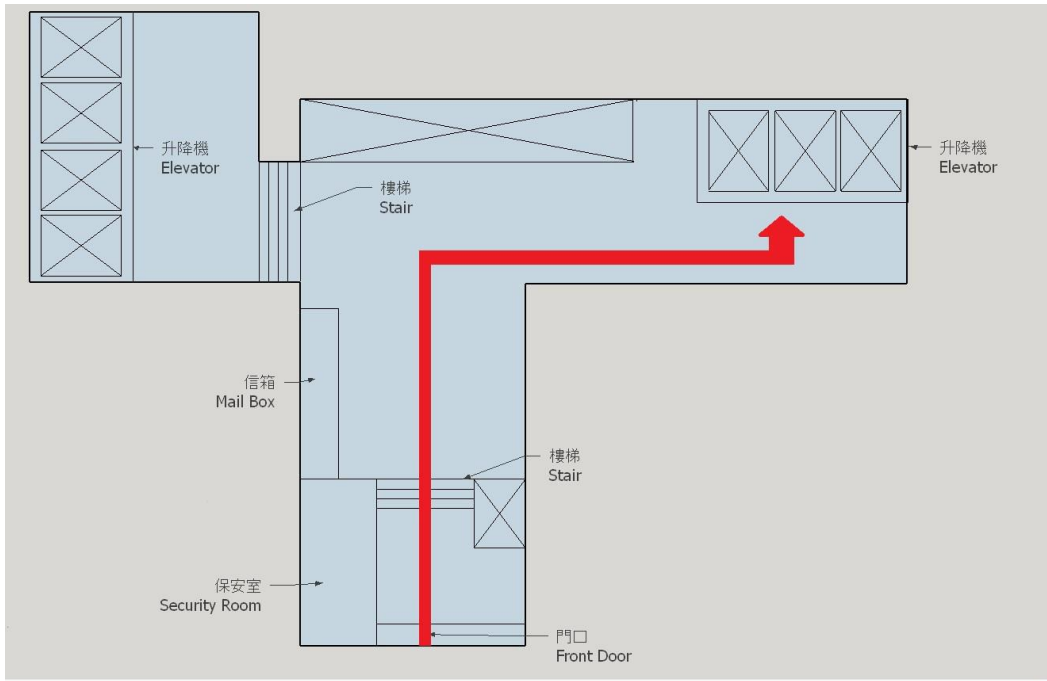

Enter Mai Luen Industrial Building lobby, then turn right, and take the elevator up to 3<sup>rd</sup> floor.

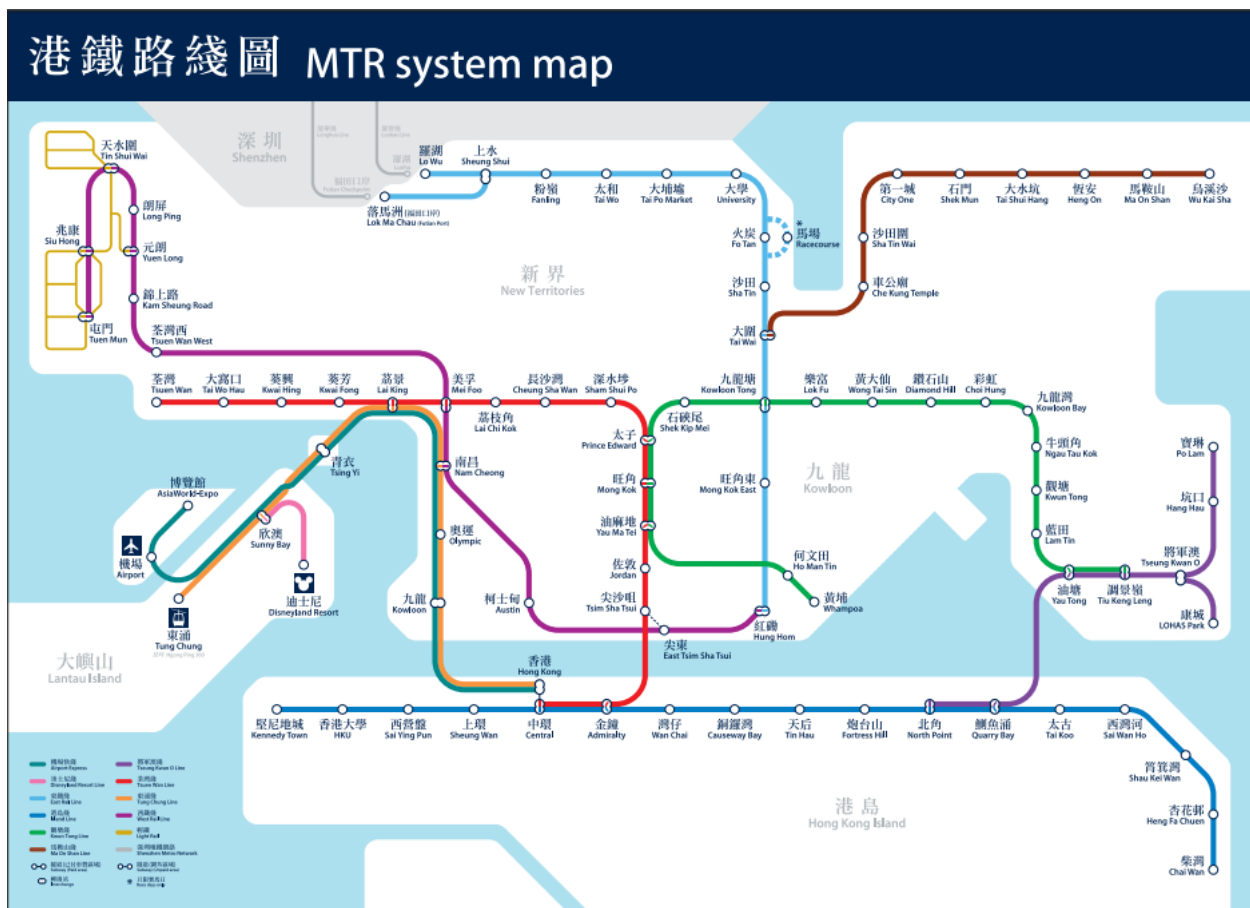

\*For your own safety and benefit, we suggest our customer to use licensed and reliable public transportation.

\* The above information and price are for reference only, the actual charges may be difference as above.